



As with all Pro series cameras, the Day & Night 3MP HD IR IP camera IPR732 incorporates Sense up+, a unique technology that successfully delivers stunning video in low-light conditions. Featuring high-efficiency IR-LEDs provide 30 meters of light. Utilizing intelligent image signal processing, AGC control, and 3D Noise Reduction, this model successfully delivers the ultimate low-light image without motion blur. The IPR732 is capable of producing four independent video streams, different streams can be set for different applications, depending on the individual user requirements. The IP66-rated housing is designed to help the camera body withstand rain and dust and ensures operation under a multitude of harsh weather conditions.

#### FEATURES :

- Full HD 3.27 megapixel CMOS image sensor
- True H.264 AVC/MPEG-4 part 10 real-time Video compression
- H.264 and Motion JPEG multi-profile Video streaming
- 3D Noise Reduction (MCTF)
- 2D WDR function
- Digital PTZ supported
- Face / Tampering / Motion detection
- High efficiency IR LED, Radiant distance up to 30m
- Day & Night (IR cut removable)
- ONVIF supported
- Digital I/O : 1 in, 1 out
- ONVIF supported

#### DIMENSIONS : (Unit : mm)

Body : 82 x 72.5 x 154(W x H x D) Bracket: 101(L)

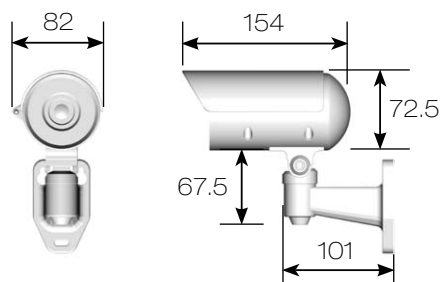

#### INSTALLATION HOLE SITE DIAGRAM :

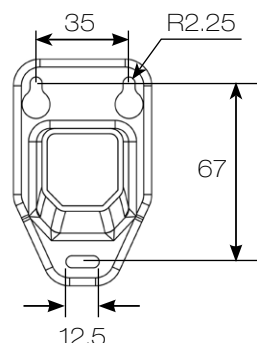

## SPECIFICATION :

Name		Day & Night 3MP HD IR IP Camera		
Model		IPR732ES4.3	IPR732ES6	
Lens	Focal length	4.3 mm	6 mm	
	Iris	F1.6	F1.8	
	Angle of view	H	70°	49.3°
		V	51°	35.9°
D		89°	64.5°	
Pick up element	1/2.8" CMOS image sensor			
Effective pixels	2096 (H) x 1561 (V) = 3,271,856 (pixel)			
Chip size	7.96mm (H) x 7.61mm (V)			
Scanning system	Progressive scan			
Infrared cut filter	Auto / schedule / day (color) / night (mono)			
Min. illumination	0.25 Lux at F1.6 (Low light mode) / 0 Lux with IR LED on	0.3 Lux at F1.8 (Low light mode) / 0 Lux with IR LED on		
White balance	Auto / tungsten / indoor / fluorescents1 / fluorescents2 / outdoor1 / outdoor2			
Back light compensation	Off / on			
Electrical shutter	1/30s – 1/8000s			
Sense up	Off / 1 frame / 2 frames / 3 frames / 7 frames			
Sense up +	Yes			
Auto gain control	36 dB variable gain			
3D Noise Reduction	Off / 1 – 32 selectable			
2D WDR	Off / auto / x2 / x3 / x4			
Privacy masking	Off / on (4 zones)			
Image effects	Brightness, contrast, hue, saturation, sharpness, mirror, flip			
IP rating	IP66			
Window	Ø65 heat resistant glass			
Infrared LED	Peak wavelength	850nm		
	Beam spread	30°		
	Radiant distance	30M		
Operating temperature	-40°C – +50°C (-40°F – 122°F)			
Dimension	Body : 82mm(W) x 72.5mm(H) x 154mm(D) / Bracket : 101mm(L)			
Weight	600g			
Power supply	DC12V ±10% / PoE (IEEE 802.3af compliant)			
Power consumption	DC12V, 9W / PoE, 10.2W			
<b>Network</b>				
Video compression	H.264 , Motion JPEG			
Resolution	3MP(2048 x 1536), 1080P(1920 x 1080), 720P(1280 x 720), D1(720 x 480), CIF(352 x 240)			
Multiple profile	Profile #1	H.264 : up to 30 FPS @ 1920 x 1080, MJPEG : up to 30 FPS @ 720 x 480		
	Profile #2	H.264 : up to 30 FPS @ 1280 x 720, MJPEG : up to 30 FPS @ 352 x 240		
	Profile #3	H.264 : up to 30 FPS @ 1920 x 1080, MJPEG : up to 30 FPS @ 1280 x 720		
	Profile #4	H.264 : up to 30 FPS @ 720 x 480, MJPEG : up to 15 FPS @ 1920 x 1080		
	Profile #5	H.264 : up to 15 FPS @ 2048 x 1536, MJPEG : up to 15 FPS @ 720 x 480		
Video streaming	RTP/HTTP, RTP/TCP, RTP/UDP, Multicast			
Video bitrate	128Kbps – 5Mbps			
	Frame rate and bit rate controllable on-the-fly			
	VBR / CBR / GOP supported			
Security	base64 HTTP encryption			
	Multiple user access levels with password protection			
	10 user accounts available			
Users	8 simultaneous users			
ePTZ & digital zoom	Yes, ROI is supported			
OSD	Text overlay for date, time, and camera name			
Alarm function	Motion / tampering / face detection triggering recording into SD card			
	Image upload over FTP and E-mail by face / tampering / motion detection			
CPU, memory	Embedded SoC ARM11, 528MHz, 256MB DDR2, 256MB flash memory			
Maintenance	Firmware update via HTTP			
	Firmware available at web site			
Network interface	10Mbps / 100Mbps Base-T, RJ-45			
PC requirement	OS : Windows 2000, Windows XP, Windows Vista, Windows 7, Windows 8			
	Browser : Windows Internet Explorer 6.0 or above			
	CPU : intel pentium 4 1.8GHz or above			
	RAM : 1GB or above, independent display card			
Network protocols	IP, TCP, UDP, HTTP, SMTP, NTP, DDNS, UPnP, FTP, ARP, DHCP, PPPoE, DNS, RTSP, RTCP, Telnet, ICMP, IGMP, ONVIF Profile S, SNMP, SIP, Bonjour			
Mobile phone	iPhone, iPad, and Android support			
System integration	ONVIF & LILIN HTTP API			
Central management system	CMX 3.6 / NAV 1.0 support			
Video display	LILIN Universal ActiveX & LILIN Java Applet			
OS	Embedded Linux 2.6.32			
SD card recording	Support Micro SD/SDHC card for circular recording (card is not included)			