

JVC®

The Perfect Experience

Vandal-Resistant Dome Range

FIXED NETWORK DOME CAMERA

VN-V225VPU

FIXED MEGAPIXEL NETWORK DOME CAMERA

VN-X235VPU

NETWORKS

**MEGA
PIXEL**

VN-X235VPU

*progressive
Scan*

**IR Cut Filter
Day/Night**

PoE
Power over Ethernet

**DUAL
STREAM**

**Bi-Directional
Audio**



A tough network dome camera fully featured for demanding environments, and includes JVC new "Fine Adjust" focusing [Patent Pending]

- 1.3 Megapixel High-Quality JPEG Stream [VN-X235VPU only]
Up to Quad VGA (1280x960) resolution images available for precise monitoring
- MPEG-4/Motion JPEG Dual Stream
Simultaneous distribution of MPEG-4 and Motion JPEG images
- Variable-Focal Lens for Accurate Viewing Angles, and Progressive Scan CCD for Precise Clear Images
- Day/Night Function with IR Cut Filter
Automatic switching between day and night for secured round-the-clock surveillance
- Bi-Directional Audio Support
Two-way audio communication is possible when a microphone and speaker are attached

- Dust/Waterproof and Vandal-Resistant Design
IP66-standard robust design suitable for outdoor monitoring system
- Triple Axis Rotation for Flexible Lens Angle Adjustment
- Open Architecture API for Easy Customization
Various settings and customization are possible via network
- An Array of Features to Match Any Usage Environment
 - Free shape privacy mask
 - Built-in motion detection
 - PoE / 24VAC power supply
 - Bandwidth flexibility
 - Optional heater unit for use in low temperatures down to -30°C
 - JVC and Verint API compatibility
 - Web based viewer and setup screen for quick setup and monitoring

■ Distribution Priority Option for JPEG Stream **NEW!**

Two distribution modes are available according to your environment. By controlling the frame rate and the number of accessible clients, it ensures stable monitoring all the time.

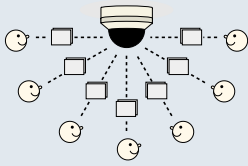

Priority to Client Number

Automatically adjusts the frame rate according to the number of clients accessed and assures distribution to all clients (up to 20).

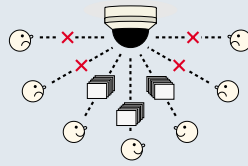

Priority to Frame Rate

Always maintains requested frame rate by clients though number of clients is limited by requested frame rate.

■ Digital PTZ with Preset Patrol Function **VN-X235VPU only**



Select up to 20 clipped areas from within the original image. These areas can be sequentially switched "Auto Patrol", so the viewer concentrates only on the important zones.

Original angle (Home)

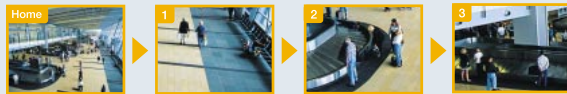

■ JVC-Designed Fine Focus Adjustment Technology **NEW!**

For assisting focusing to the finest point, the Variable-Focal lens now incorporates a newly developed focus screw mechanism (Patent Pending).

Normal Focus ring and lock screw



Patent Pending

New "Fine Adjust" screw

With a very subtle movement, finer, more accurate adjustment is possible.

■ IP66-Compliant Rugged Body for Any Installation Location

Ideal for installing in stores, banks or schools regardless of whether it's indoors or outdoors.

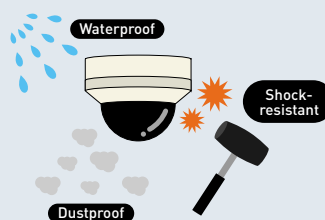

■ Specifications

	VN-V225VPU	VN-X235VPU
Image device	"Exview HAD CCD" 1/4" Progressive scan Approx. 330,000 pixels	"Exview HAD CCD" 1/3" Progressive scan Approx. 1,250,000 pixels
Lens	3.8x 2.8-10.5mm varifocal, F1.2	
Day/Night	Automatic/Manual Day/Night IR cut filter	
Minimum illumination	0.4 lx (Color, 50%, AGC SUPER) 0.03 lx (B&W, 50%, AGC SUPER)	0.8 lx (Color, 50%, AGC SUPER) 0.08 lx (B&W, 50%, AGC SUPER)
Camera angle adjustment	Pan 350°, Tilt ±70°(140°), Rotation ±175°(350°)	
Picture compression	Motion JPEG MPEG-4: Part2 (ISO/IEC 14496-2), Profile: SP	
Picture resolutions	640x480, 320x240	1280x960 (JPEG), 640x480, 320x240
Frame rate and streaming	Up to 30 fps M-JPEG and MPEG-4 simultaneously	Up to 15 fps M-JPEG and MPEG-4 simultaneously
Compression levels	JPEG: Variable (VFS) 7 levels / Average (AFS) Quad VGA 40KB-200KB, VGA 10KB-100KB, QVGA 3KB-33KB (Quad VGA: VN-X235VPU only) MPEG-4: Constant (CBR) / Variable (VBR), Bit rate adjustable 64kbps – 8000kbps	
Image settings	Configurable AGC, Sens-up, Day/Night, Shutter speed, BLC, White balance (ATW/AWC), Gamma curve, Black level, Enhance range, Color level, Exposure value, Monitor type, Free shape Privacy mask, Time/date/camera ID overlay	
Digital PTZ	-	20 preset positions, Auto patrol, Auto return, 8x digital zoom
Shutter speed	2 sec (Sens-up) to 1/10000 sec	1.5 sec (Sens-up) to 1/10000 sec
Audio	Two-way (full/half duplex) or one-way External microphone input (plug-in power condenser mike) and output (line level) Audio compression: μ-law 64kbps, AD/DA 16bits Fs=8kHz	
Security	3 levels password, IP address filtering	
Max. clients	20 simultaneous users, Unlimited users by multicast	
Alarm/Event management	Trigger: Built-in motion detection, External alarm input x 2 or Schedule Event: Pre/post recording, FTP sending, Notification over TCP/UDP, E-mail, External output x 2, sound output, preset position (VN-X235VPU only) Pre/Post alarm buffer of 8MB	
Connectors	RJ-45 for Ethernet 10Base-T/100Base-TX/FULL/HALF/Auto negotiation Wires for 2 alarm input and 2 output RCA jack monitor out (for installation) Wires for alternative power connection Wires for mike in and line out	
Dust and water protection	IP66	
Power	24 VAC (50Hz/60Hz), 0.35A, 1.0A with optional heater 48 VDC (PoE), 7W	
Operating temperature	-10°C to 50°C/14°F to 122°F (0°C to 40°C/32°F to 104°F recommended) -30°C to 50°C / -22°F to 122°F with optional heater (24VAC power supply required)	
Installation and maintenance	Web based setup screen, Camera search tool, Firmware update over HTTP	
Minimum web browsing environment	OS: Windows Vista Business (SP1), Windows XP Pro (SP2) / Home (SP2) CPU: Pentium 4 1.5GHz (VN-V225VPU) / Pentium 4 2GHz (VN-X235VPU) Memory: 1GB, HDD space: 512MB Display and video card: 1024x768 (VN-V225VPU) / 1600x1200 (VN-X235VPU) True color (24bit or 32 bit) VRAM8MB Browser: IE7.0 for Vista, IE6.0 for XP	
Supported protocols	TCP/IP, UDP/IP, HTTP, FTP, ICMP, ARP, RTP, DHCP, SNMP, SMTP, DSCP, IGMP, IPv6, VSIP	
Video management software/hardware (not included)	VR-N900U/1600U/1600E: JVC Network video recorder for viewing, recording and archiving up to 9/16 cameras. VN-RS800U: JVC free video management software for viewing, recording and archiving up to 32 cameras. (JPEG stream only)	
Dimensions	ø160mm x 125mm (ø6-1/4" x 4-7/8")	
Weight	Approx. 1.3kg (2.9lbs)	
Option	KA-ZH215U : Heater unit	

■ Dimensions

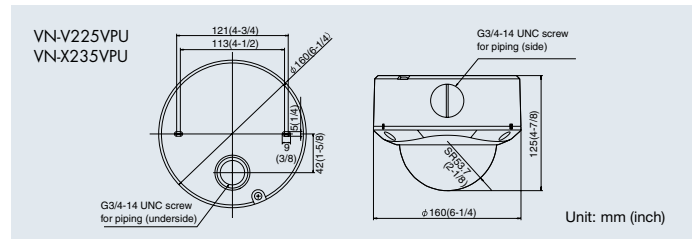

"EXview HAD CCD" is registered trademarks of Sony Corporation. All brand or product names may be trademarks and/or registered trademarks of their respective owners.

Copyright © 2009, Victor Company of Japan, Limited. All Rights Reserved.

JVC®

DISTRIBUTED BY



Design and specifications subject to change without notice.



■ Hachioji Business Centre of Victor Company of Japan, Ltd. has received ISO14001 Certification for environmental management and ISO9001 Certification for quality assurance management.

Printed in Japan

VEC-0329 VN-V225VPU / X235VPU

"JVC" is the trademark or registered trademark of Victor Company of Japan, Limited.